

Newbourne Range

Multifuel Stoves
for the home



DESIGNED
IN THE UK



Warming your world



Newbourne Range

Bring your living room to life with a multifuel stove



The Newbourne Multifuel Range offers a collection of British-designed stoves featuring both free-standing and inset models, with heat outputs up to 8kW.

This superb collection

has been designed not only as attractive appliances for the home but also as high performance stoves, able to meet the environmental requirements of today and tomorrow and approved for use in smoke control areas throughout the UK. The Newbourne Range offers contemporary and sleek designs with the latest technology in primary air control plus a secondary air wash which effectively keeps the fire window clean, and tertiary air to ensure a clean burn high-efficiency performance, whether burning wood or smokeless fuel.

There is nothing quite like a living flame fire to make a room warm and cosy, where you can appreciate and enjoy the mesmerising dancing flames and wonderful heat that these stoves can produce. But not only will a Newbourne Multifuel stove give superb performance and a long, trouble-free life, they are supported by a **5-year manufacturer's guarantee***, so you know in choosing a Newbourne model from Pevex, you will always have peace of mind.



Contents

Newbourne 35FS	4
Newbourne 40FS/50FS/60FS Range	6
Newbourne 40FS/50FS/60FS Panorama Range	8
Newbourne 40i Inset Multifuel	10
Optional Extras	11

Newbourne 35FS 2-5kW Multifuel

The smallest multifuel stove in the Newbourne Range, making it ideal for installation into small fireplaces and today's smaller homes.

Although small in size, it is big in features with 80% efficiency, stylish good looks and excellent heat output. A full size curved door and large viewing window gives an impressive view of the fire burning beautifully yet efficiently in the fire chamber. With a portrait design, the stove is ideal for installation in canal boats, townhouses or country cottages, and fits a minimum fireplace opening of 18" x 26" height, whether installed into a fireplace or a free-standing situation, to warm your home and heart.

Newbourne 35FS available with 400mm high stove stand option. (illustrated below)

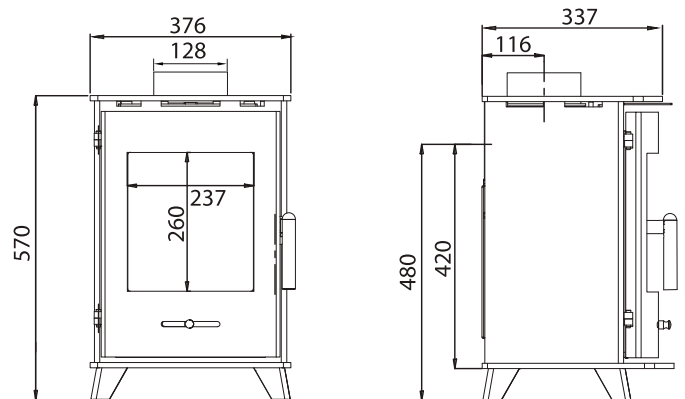

All Measurements in mm



Small in size, but big in performance, the 35FS offers excellent output of 4kW nominal heat

- *Output range of 2-5kW*
- *Pevelex clean burn technology*
- *Designed for multifuel use*
- *Cool touch handle*
- *Optional 110mm and 160mm leg lengths available*
- *400mm high stove stand available*
- *Optional rear heat shield to reduce clearance to combustibles to 150mm*
- *300mm log length*
- *Convection top plate*
- *Suitable for use in smoke control areas*

Newbourne 40FS, 50FS, 60FS Range

Offering heat outputs of 4-8 kW with clean burn performance

Stylishly designed in the UK

and beautifully made, the stove will look fabulous in your fireplace with its wonderfully curved door offering a remarkable large picture window of the fire burning lazily in the fire chamber. With simple to operate air slider controls and built-in tertiary air, the Newbourne stove offers clean burn performance with efficiencies of 80% whilst producing a lovely warming radiant and convection heat, leaving you delighted and entirely satisfied.

The range includes 200mm and 400mm high stove stand options. (illustrated below)

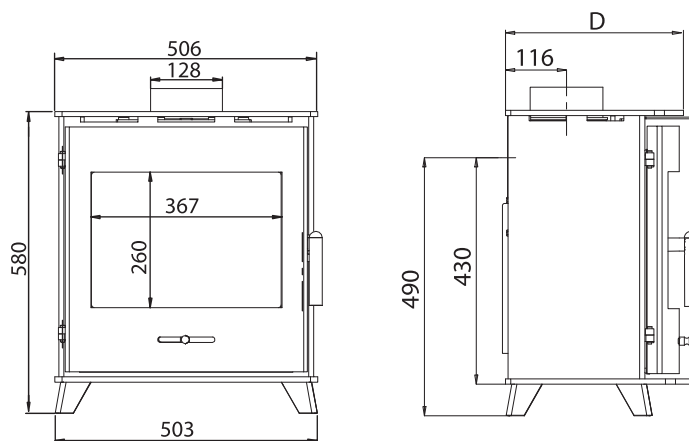

40FS D = 338mm 50FS D = 377mm 60FS D = 434mm
All Measurements in mm



Available in 3 outputs as a 40FS (4.5kW), 50FS (5.5kW) and 60FS (7kW) model variants

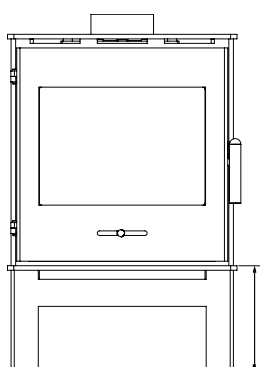

200mm & 400mm high optional stove stand available

- Available in nominal output 4.5kW, 5.5kW, 7kW
- Designed for multifuel use
- Heavy-duty construction
- Clean burn with efficiencies of 80%
- EN1320 and Defra approved
- Cool touch handle
- Convector top plate
- Built-in airwash
- Suitable for use in smoke control areas
- Optional 110mm and 160mm long leg lengths
- Optional 200mm and 400mm high stove stand
- Optional rear heat shield to reduce clearances to combustibles to 180mm

Newbourne 40FS, 50FS, 60FS Panorama

Featuring large panoramic front and side windows, the Newbourne Panorama Range has been designed to be a stunning addition to any room

The Newbourne Panorama

is an ideal choice for a free-standing installation or in larger open fireplaces where the fire in the fire chamber can be seen and enjoyed through the front and side windows. Available with high-performance nominal output of up to 7kW. You will be mesmerized and enchanted by viewing the dancing flames from each direction, making this a stunning addition to your room and home.

*200mm or 400mm high stove stands are available to order.
(illustrated below)*

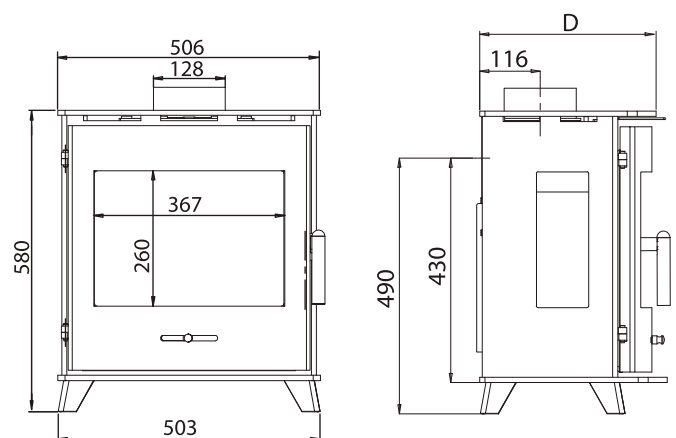

40FS D = 338mm 50FS D = 377mm 60FS D = 434mm
All Measurements in mm

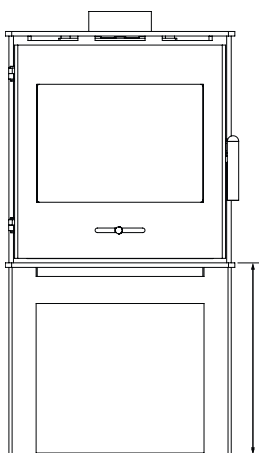

200mm &
400mm high
optional stove
stand available

Available in 3 outputs as a 40FS (4.5kW), 50FS (5.5kW) and 60FS (7kW) model variants

- Available in nominal output 4.5kW, 5.5kW, 7kW
- Designed for multifuel use
- Heavy-duty construction
- Clean burn with efficiencies up to 80%
- Cool touch handle
- Convector top plate
- Stay-clean side windows
- Built-in airwash
- EN13240 and Defra approved
- Optional 110mm and 160mm long leg lengths
- Optional 200mm and 400mm high stove stand
- Optional rear heat shield to reduce clearances to combustibles to 180mm

Newbourne 40i Inset Multifuel

Offering an impressive 4.5kW nominal output of clean burn performance, with a built-in air wash to ensure that the fire window remains clean throughout the stove's use

The Newbourne 40i Inset

offers the same strikingly good looks and simple operation as the Newbourne free-standing range but with the advantage that it is designed to fit directly into an existing 16" x 22" British fireplace opening and will instantly improve the look and efficiency compared with the existing open fire*.

The Newbourne 40i Inset offers 4.5kW output, a large picture window, multifuel use, convection side legs and top plate, clean burn performance with built-in tertiary air and easy to use air controls.

Easy installation, and can be installed with or without a flue liner.

*Existing fireplace must be suitable for solid fuel use

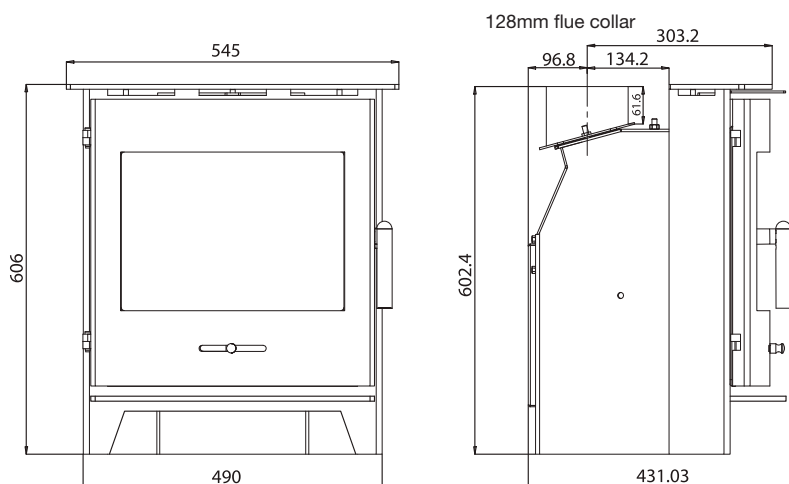



Newbourne optional extras

Optional extras are available on all models, from stove stands designed to elevate the stove for easier loading and storage of logs, to a choice of black or brushed steel handles and knobs.



Chrome Black Brushed Steel

Handle and air controls

All Newbourne Stoves are fitted with chrome cool-to-touch door handle and matching air controls as standard. These are also available in black or brushed steel.



Stove Stands

Free-standing Newbourne Stoves are available with a stand. This optional stand allows for easier access and loading and is available in 200mm and 400mm* heights.

*400mm height only available for the 35FS model

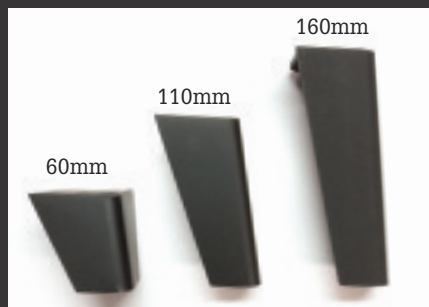

Optional leg heights

Three different leg heights can be specified to elevate your stove – 60mm standard height with options of 110mm and 160mm available.

Flue Collar Offset Adapter

Allows the flue collar to be set back 150mm behind the stove.

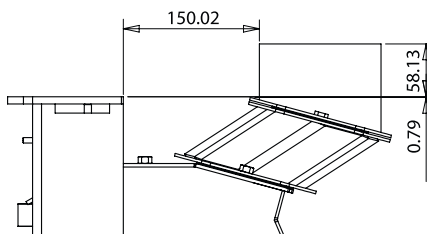
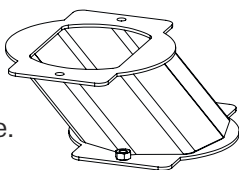

A striking inset stove featuring simple operation

- 4.5kW nominal output
- Designed for multifuel use
- Clean burn with efficiency of 79%
- Cool touch handle
- Built-in airwash
- Convection sides and top plate
- Optional offset flue adaptor available
- EN 13240 and Defra approved
- Suitable for use in smoke control areas

Note: Fixtures and fittings in room sets throughout this brochure were provided by Glasswells (www.glasswells.co.uk/)



Warming your world

Pevex Enterprises Ltd

Tel: 01473 736399 Fax: 01473 736406

www.woodstoves.co.uk

sales@woodstoves.co.uk

Your PEVEX dealer is: